

**KORIDOR  
UTILITI**  
DARUL RIDZUAN



**TENAGA  
NASIONAL**

**MSVT (D-SER-S25-1979)MSVT MERENTANG KABEL XLPE 3C 240MMP DARI  
SSU HOSPITAL BARU KE PE SIMPANG 5 SEPANJANG 190M**

**PELAN IZIN LALU**

**NO FAIL RUJUKAN  
KUDR/TNBS/B/11/25/0942**

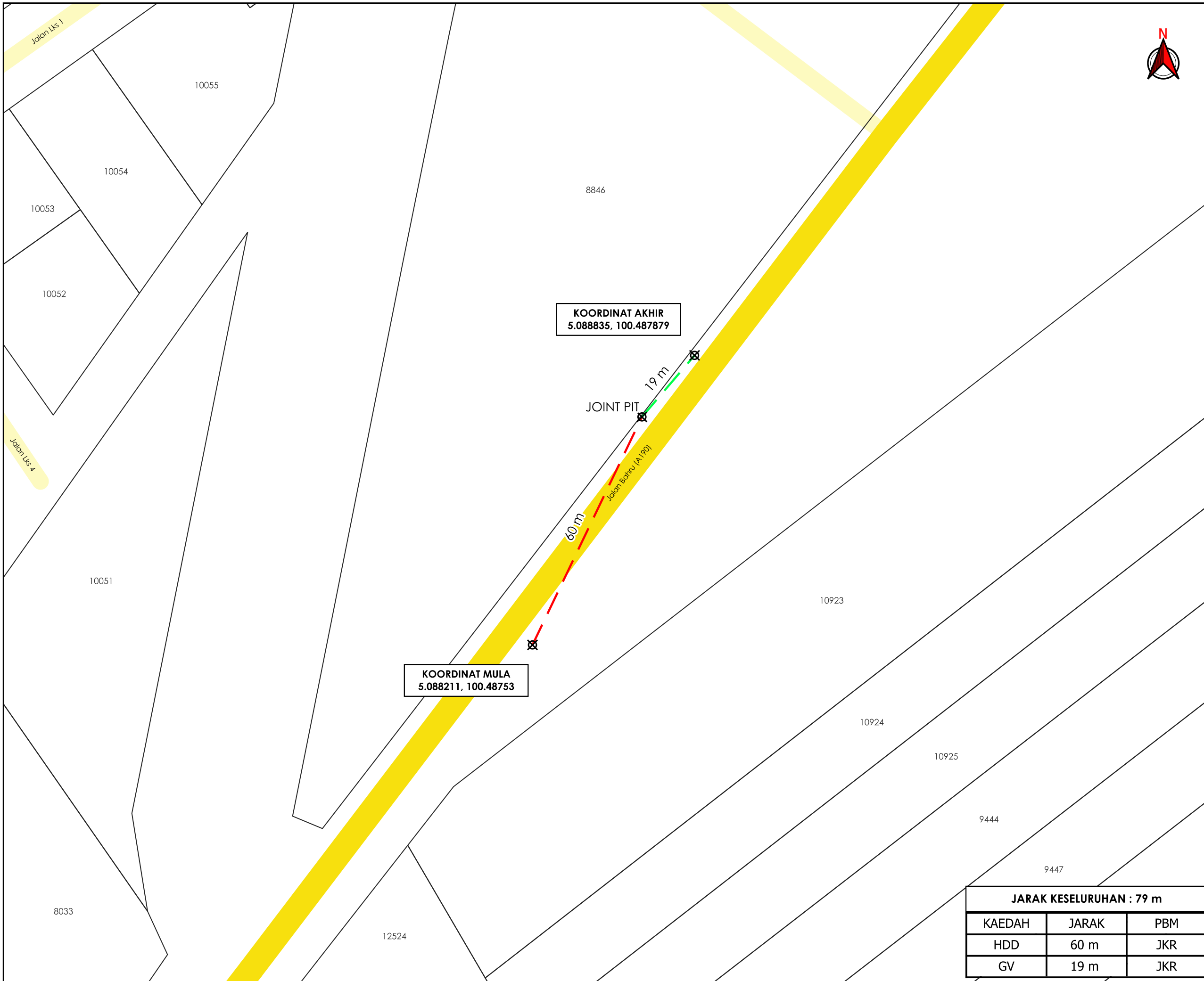

**KOORDINAT AKHIR**  
5.088835, 100.487879

**KOORDINAT MULA**  
5.088211, 100.48753

JOINT PIT





60 m

19 m

Jalan Bahru (A-190)

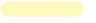

**TAJUK PERMOHONAN**  
MSVT (D-SER-S25-1979)MSVT MERENTANG KABEL XLPE 3C 240MMP DARI SSU HOSPITAL BARU KE PE SIMPANG 5 SEPANJANG 190M

- PETUNJUK**
-  JALAN JKR
  -  JALAN PBT
  -  GRASS VERGE
  -  HORIZONTAL DIRECTIONAL DRILLING
  -  TITIK MULA AKHIR

**PIHAK BERKUASA MELULUS**

	JABATAN KERJA RAYA KERIAN

**PENYEDIA UTILITI**



<b>JARAK KESELURUHAN : 79 m</b>		
KAEDAH	JARAK	PBM
HDD	60 m	JKR
GV	19 m	JKR

JENIS PELAN	PELAN IZIN LALU
PELUKIS PELAN	ADIB FARHAN
TARIKH DIKELUARKAN	2025-11-25
MUKA SURAT	1/1
NO FAIL RUJUKAN	PINDAAN
KUDR/TNBS/B/11/25/0942	<b>00</b>

**\*PENGUKURAN BERDASARKAN JARAK SATELIT**